



Name of Distributor: \_\_\_\_\_ Date: \_\_\_\_\_

Phone Number: \_\_\_\_\_ Fax Number: \_\_\_\_\_

Contact: \_\_\_\_\_ Email: \_\_\_\_\_

Dealer Name: \_\_\_\_\_ Contact: \_\_\_\_\_

Phone Number: \_\_\_\_\_ Project Name: \_\_\_\_\_

**Fax completed form to 520-790-7127 or email to customrails@inter-fab.com**  
**QUOTES ARE ONLY SENT TO POOL DISTRIBUTOR; INTER-FAB WILL NOT QUOTE DEALER OR HOMEOWNER DIRECT.**

**MUST BE COMPLETED TO QUOTE:**  Commercial Use

**TUBING SIZE:**  1.90 x .049;  1.90 x .065;  1.90 X .109;  1.90 X .145

**STAINLESS STEEL GRADE:**  304 (Pool Grade);  316L (Marine Grade)

**COATING:** Powder Coating:  White;  Earth;  Copper Vein;  Hammertone Gray;  Light Gray  
Please note that 4" will be taped off bottom of rail when powder coated. If only 3" is to be taped off, please indicate on Purchase Order.

Thermo Plastic Coating:  White;  Tan;  Gray

All Thermo Plastic Coated rails are encapsulated in plastic coating and sealed at the ends with plastic caps.

**CUSTOM LADDER DESIGN**

All dimensions should be indicated in inches and REQUIRE the following information using CENTERLINE dims:

\_\_\_\_\_ **A** = Height from Deck to Top of Ladder

\_\_\_\_\_ **B** = Horizontal Span

\_\_\_\_\_ **C** = Length from Deck to Bottom of Ladder

\_\_\_\_\_ **D** = Distance from Deck to 1st Tread

\_\_\_\_\_ **E** = Distance between Treads

Check for Cross Brace

\_\_\_\_\_ **F** = For Cross Brace (ONLY) – Height from Deck to Bottom of Brace

\_\_\_\_\_ Number of Treads

**TYPE OF TREAD:**  SUT (Stainless Steel Sure Step Tread)

HIP (High Impact Plastic - Residential Only)

HARTLEY (PC or TPC Only)

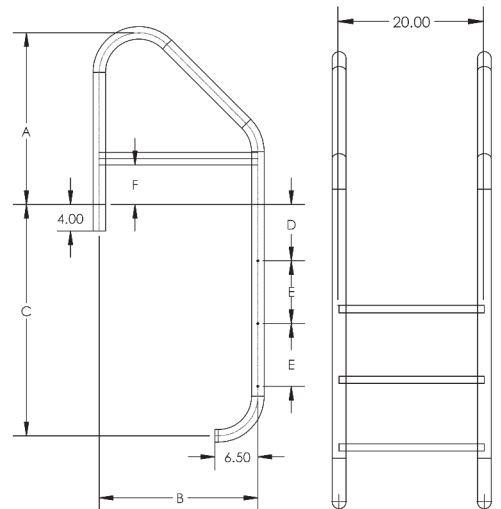

**CUSTOM GRAB RAIL DESIGN**

Pair  Single

All dimensions should be indicated in inches and REQUIRE the following information using CENTERLINE dims:

\_\_\_\_\_ **A** = Height from Deck to Top of Rail

\_\_\_\_\_ **B** = Distance from Deck to Centerline of the Lowest Horizontal Span

\_\_\_\_\_ **C** = Dimension between Deck Posts of Rail (anchor position)

\_\_\_\_\_ **D** = Dimension between Back of Deck Leg and the Center of the Forward Bend

